

Welcome to the Pan American Life Center's Conference Center. We are centrally located in the CBD with access from any place within the metropolitan area including hotels and the French Quarter. We offer outstanding facilities for conferences, meetings, receptions, luncheons, video conferencing and other media services.

## FEATURES

- Technologically advanced 24,451 SF, multi-purpose facility, featuring our 252-seat theater-style auditorium
- One point-of-contact to guide you through the planning process from beginning to end
- Full in-house catering by Café 601, with customizable menus available.
- Can accommodate groups from 2 to 500
- Ideal for business meetings, luncheons and receptions
- Complete reception and meeting packages available
- Full audio-visual services available, including video conferencing

ROOM	DIMENSIONS	SQ. FT.	HALF DAY	FULL DAY	CLASSROOM	CONFERENCE	U SHAPE	HOLLOW SQUARE	BANQUET ROUNDS	THEATER	RECEPTION
AUDITORIUM	84' x 84'	4032	\$660	\$1,100	250					250	
BAYOU 1	28' x 18'	504	\$80	\$140		16	14	20	18	40	
BAYOU 2	34' x 22'	748	\$110	\$190		20	20	24	18	40	
BAYOU 3	34' x 27'	918	\$165	\$250	30	35	24	30	54	60	50
BAYOU 4	20.5' x 34'	697	\$110	\$190	24	20	16	24	40	40	
BAYOU 1 & 2	62' x 32'	1280	\$220	\$360	50	30	28	34	54	90	100
BAYOU 1, 2 & 3	72' x 32'	2144	\$360	\$520	75	36	32	40	75	125	150
BAYOU 1, 2, 3 & 4	89' x 31'	2759	\$385	\$660	160				180	300	500
BIENVILLE	14.5' x 27.6'	400	\$80	\$120		20					
IBERVILLE	14.5' x 27.6'	400	\$80	\$120		20					
JAZZ	14.5' x 30'	435	\$80	\$120		20					
LAFITTE	19' x 24'	456	\$80	\$120	20	16	14	20	24	30	
MARDI GRAS 1	17.5' x 32.5'	569	\$110	\$165	30	20	24	28	24	40	45
MARDI GRAS 2	26.5' x 27'	716	\$140	\$220	40	28	24	28	30	60	70
MARDI GRAS 1 & 2	32.5' x 44.5'	1446	\$215	\$360	70	48	48	56	74	100	100
ORLEANS	28' x 73'	2044	\$190	\$385	120	50	60	70	120	150	150
PONTCHARTRAIN	32' x 32'	1024	\$165	\$250	40	28	26	32	40	70	50
RIVER	14.5' x 15.5'	225	\$55	\$80		8	6	8		12	

Poydras Street

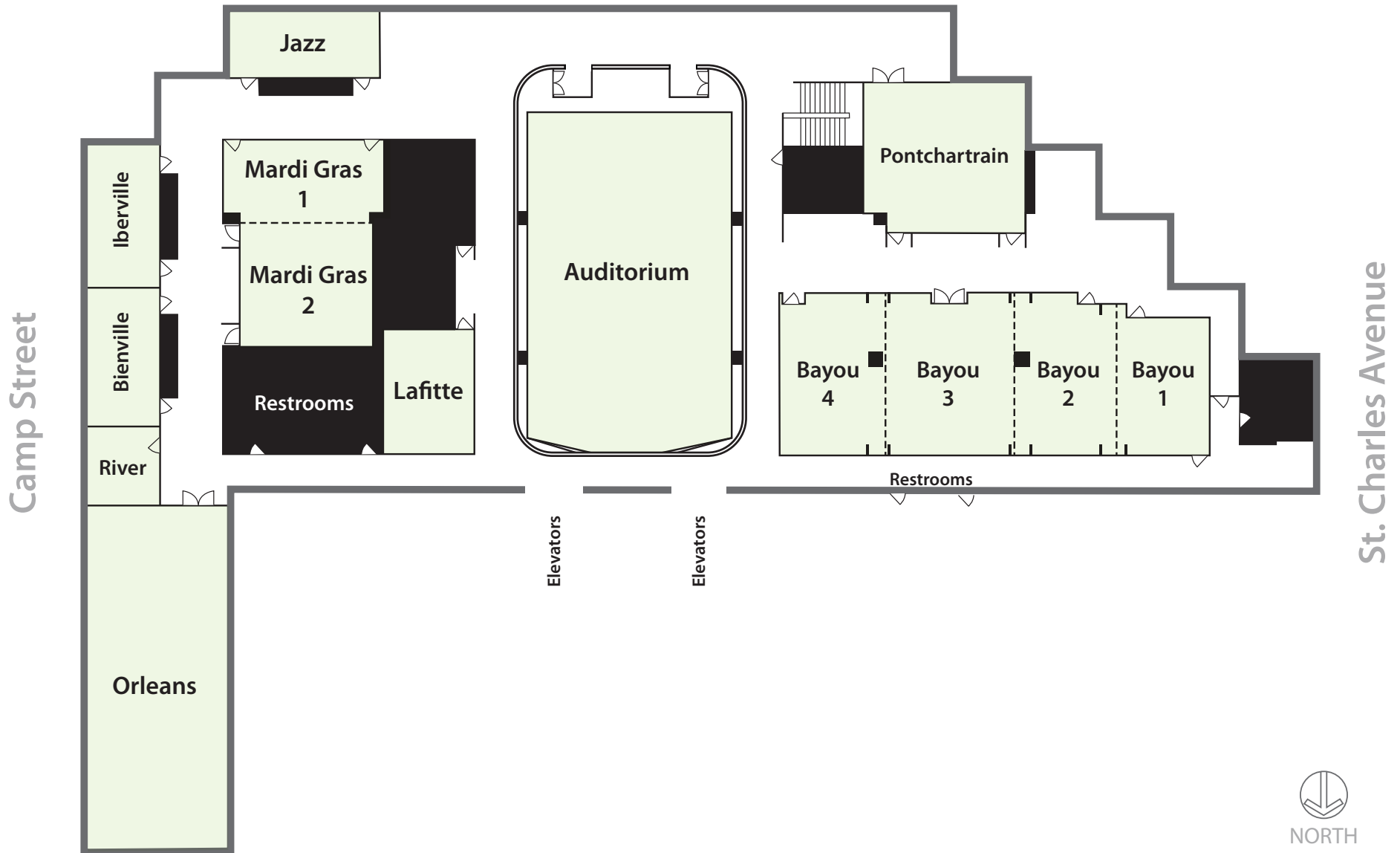

CLASSROOM

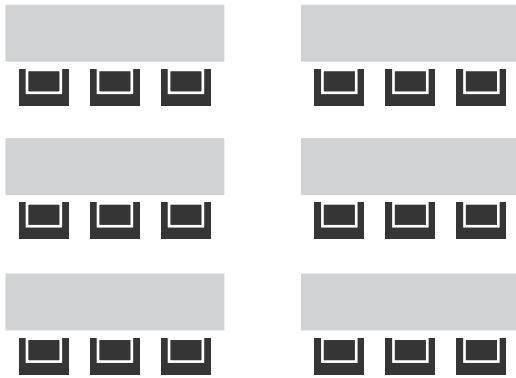

*Ideal for groups that do not have much discussion but have a need to take notes.*

CONFERENCE



*Ideal for groups under 20, with heavy discussion and a need to write or refer to materials.*

U SHAPE

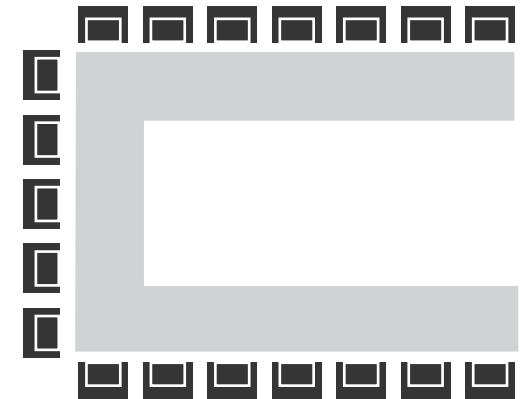

*Ideal for groups under 30, with a designated speaker, heavy discussion, and a need to write or refer to materials.*

HOLLOW SQUARE

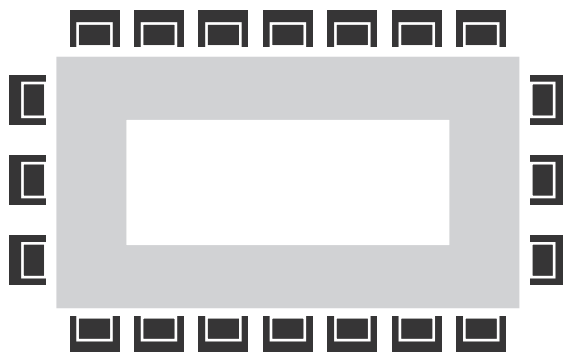

*Ideal for groups under 40, with heavy discussion and a need to write or refer to materials.*

BANQUET ROUNDS

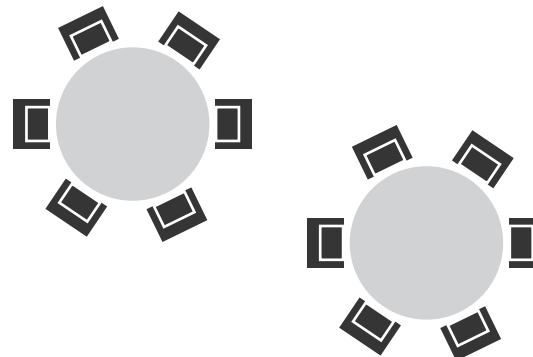

*Ideal for any size group that needs to break into smaller groups.*

THEATER

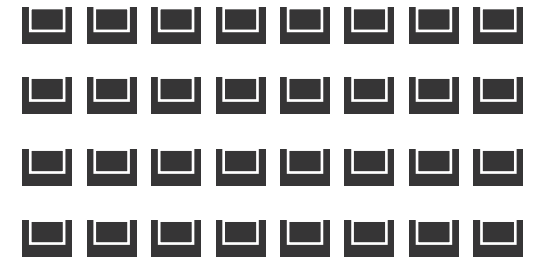

*Ideal for any size group that does not have much discussion or does not need to refer to material.*